



LED Dance Floor



High Definition



Light & Thin



Strong Load-bearing



Interactive



Easy Maintenance



Full perspective

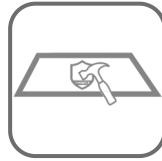

GOB protection

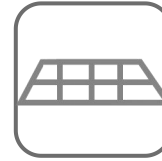

High flatness

Cabinet Size

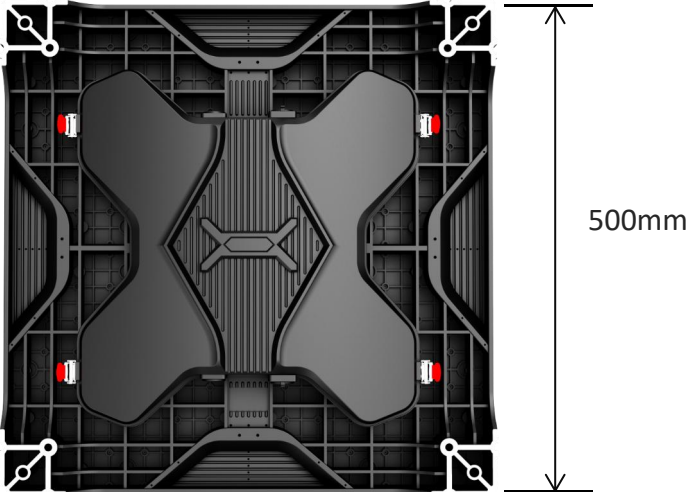
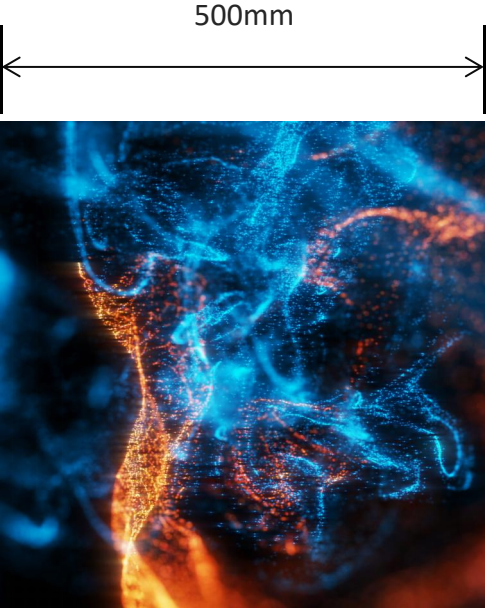



Light weight & thin

Lightweight hollow-out frame design, with a single box weighing only 10.8kg, making it slim, lightweight, and convenient.

Interactive

Equipped with built-in control chip and interactive system, 128/256 sensing points can be selected per square meter. More precise response, more sensitive response, and smooth interactive effect.



Strong Load-bearing

Professional customized high-strength die cast aluminum box with a load-bearing capacity of 2000kg/m², fearless of car crushing.



Express setup

- Set up customized foot pads for laying, accurately correspond to the support angle to achieve horizontal positioning, and quickly assemble.
- Customized adjustable feet with a height range of 15-20mm.

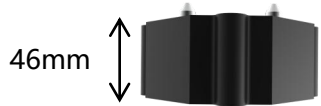
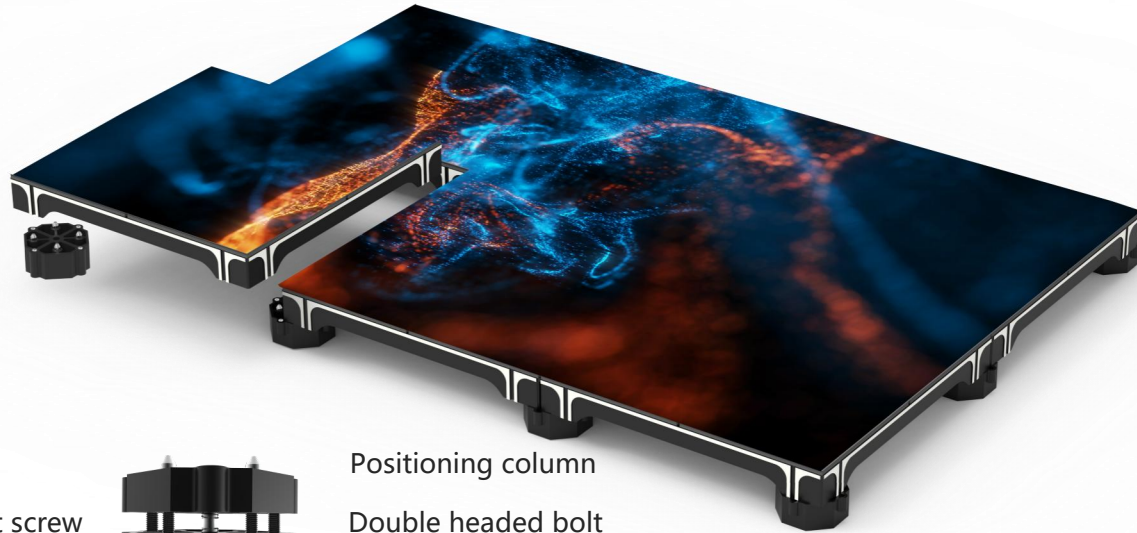

Limit screw

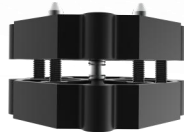

Positioning column

Double headed bolt

Fast Installation

The module adopts a magnetic pre maintenance design to achieve maintenance of the module, power supply, and receiving card, saving time and effort.

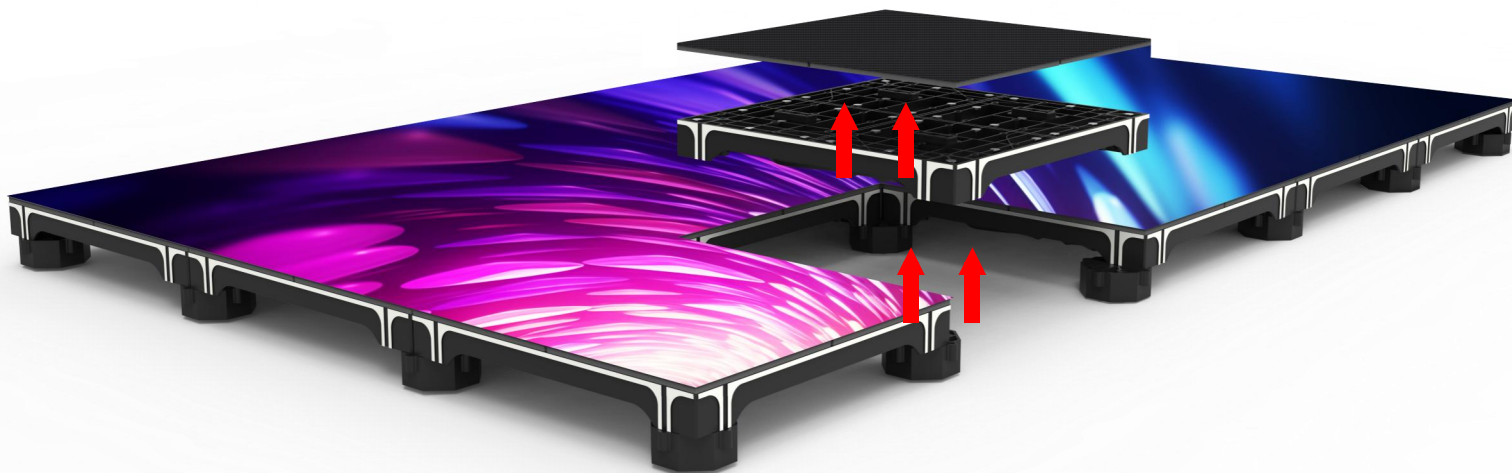

GOB protection

Adopting GOB technology, anti collision, moisture-proof, wear-resistant and easy to clean.



Support customization

We can add edging to the tile screen according to customer requirements to meet personalized needs.



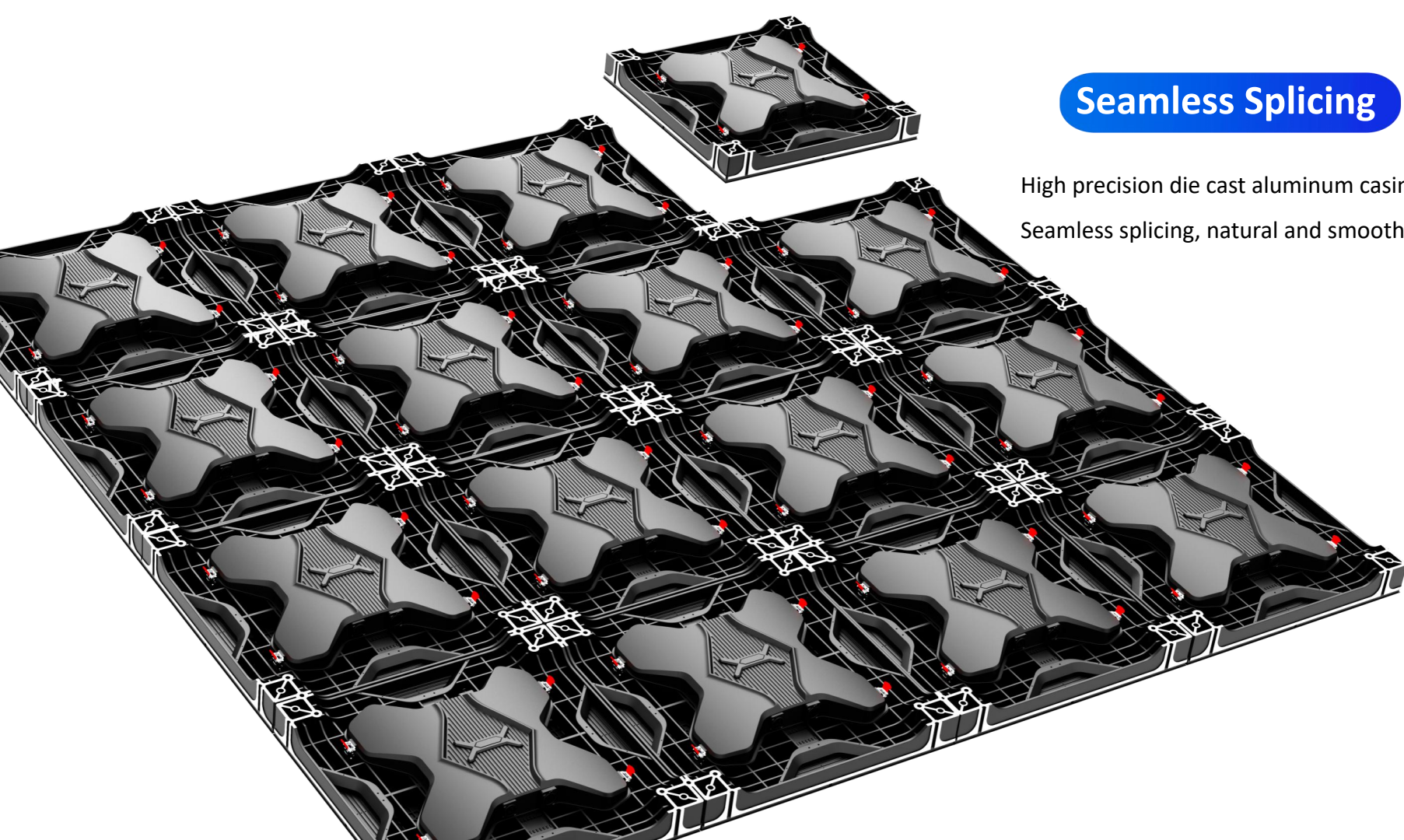

Seamless Splicing

High precision die cast aluminum casing
Seamless splicing, natural and smooth.

Full perspective

On site full perspective viewing ensures that every audience member can enjoy the ultimate visual experience.

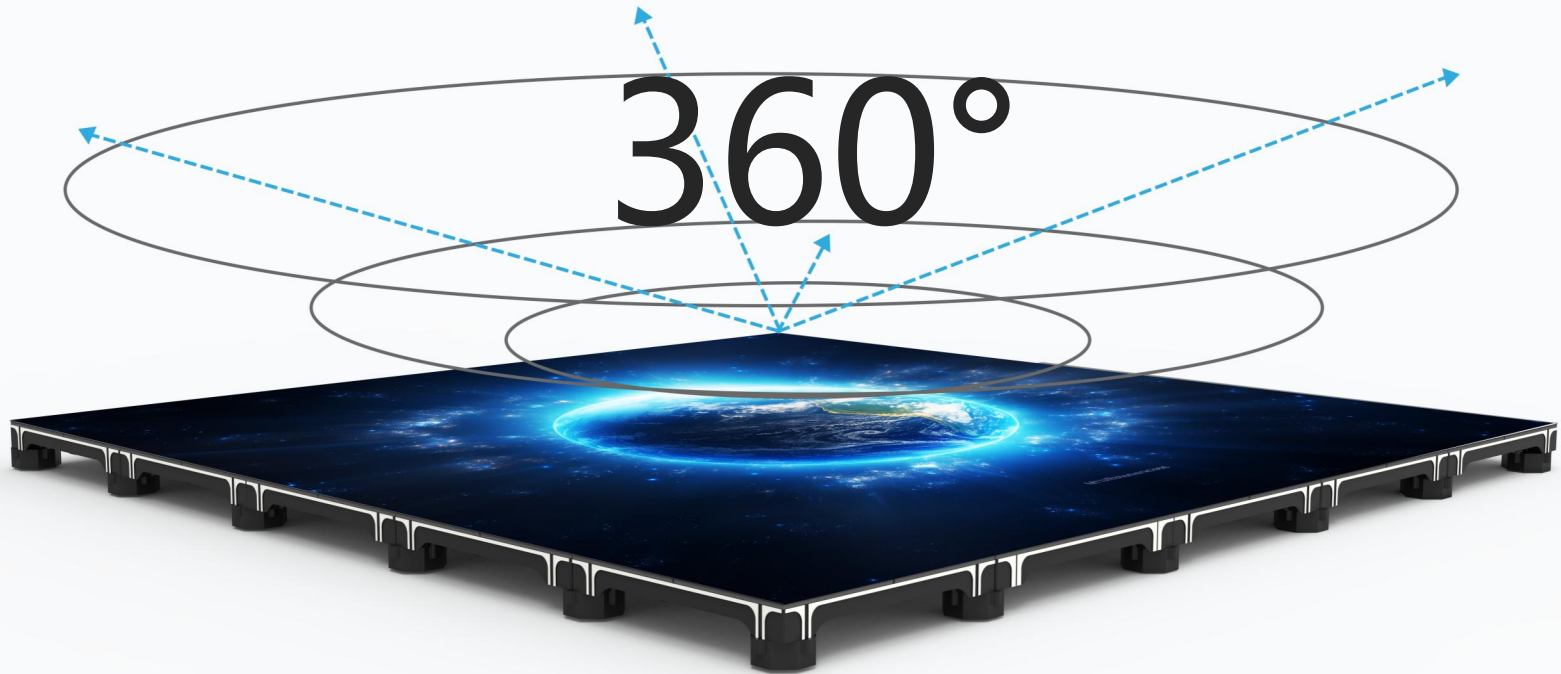

Pixel Pitch	P1.56		P1.9		P2.5		P2.604		P2.976		P3.91	
LED Type	MIP0606		SMD1212		SMD1515		SMD1515		SMD1515			
Physical Density(Dot/m²)	409600		262144		160000		147456		112896		SMD2020	
Module Resolution	160X160		128X128		100X100		96X96		84X84		65536	
Module Size(WXH)	250X250		250X250		250X250		250X250		250X250		64X64	
Cabinet Size(mm)	500X500X92		500X500X92		500X500X92		500X500X92		500X500X92		250X250	
Cabinet Resoluiton	320X320		256X256		200X200		192X192		168X168		500X500X92	
Module Quantity (WXH)	2X2		2X2		2X2		2X2		2X2		128X128	
Cabinet Weight(kg)	10.8		10.8		10.8		10.8		10.8		2X2	
Maintenance Mode	Front Maintenance		Front Maintenance		Front Maintenance		Front Maintenance		Front Maintenance		10.8	
Material	Die-cast Aluminum		Die-cast Aluminum		Die-cast Aluminum		Die-cast Aluminum		Die-cast Aluminum		Front Maintenance	
Brightness(Nits)	≥800		≥800		≥800		≥800		≥800		Die-cast Aluminum	
Color Temperature(K)	5000-12000	Optional	5000-12000	Optional	5000-12000	Optional	5000-12000	Optional	5000-12000	Optional	≥800	
Viewing Angle(V/H)	160°/160°		160°/160°		160°/160°		160°/160°		160°/160°		5000-12000 Optional	
Contrast Ratio	10000 : 1		10000 : 1		10000 : 1		10000 : 1		10000 : 1		160°/160°	
Frame Frequency	50/60		50/60		50/60		50/60		50/60		10000 : 1	
Drive Mode	1/32 scan		1/32 scan		1/20 scan		1/16 scan		1/14 scan		50/60	
Grey Scale	16bit		16bit		16bit		16bit		16bit		1/16 scan	
Refresh Rate(Hz)	3840		3840		3840		3840		3840		16bit	
Max Power Con.(W/m²)	800		800		800		800		800		3840	
Ave Power Con.(W/m²)	200-300		200-300		200-300		200-300		200-300		800	
Protection Level	IP31		IP31		IP31		IP31		IP31		200-300	
Power Input					AC90-264V,47-63Hz						IP31	
Operation T/H(°C/RH)					-20~60°C/10%~85%							
Storate T/H(°C/RH)					-20~60°C/10%~85%							
Cert.					CCC/CE/RoHS/FCC/CB/TUV/IEC							

Given the continuous iteration and innovation of the products, the parameters are provided solely for preliminary reference purposes, and the actual specifications may be subject to updates.

Application

Showroom



Hotel

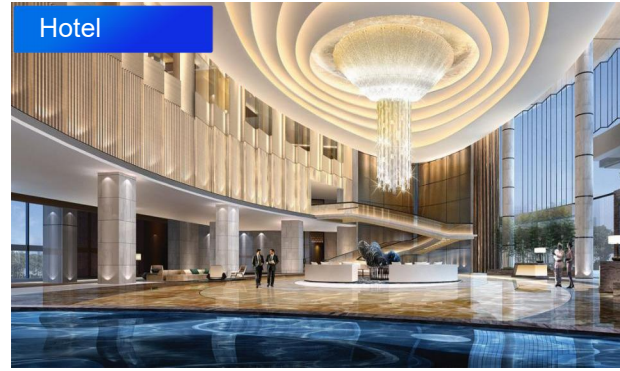

Events



shopping mall



THANKS